



On-Premises Tumble Dryers

SA055NNN

Features

- Large door opening for easy loading and unloading
 - extra strong hinge and reversible door
- Galvanized drum – oval drum holes preventing damage from standard drywall screws
- Unique drum supporting system (axial airflow only)
 - at the rear: bearing
 - at the front: rubber rolls with bearings
- Large lint filter – easy removal of lint, efficient drying
- Axial airflow
 - drum perforations only at the front and back
 - maximum airflow, less energy consumption and short drying times
- Quantum™ Gold Control
 - easy to operate, easy to program
 - flexibility of 30 programmable cycles
 - moisture sensing technology prevents overdrying, saving time and energy

Options

- Stainless steel front and drum
- Reversing: prevents tangling of the linen
- CARE (Combustion Auto Response Equipped)*
 - a response to laundry combustion
 - helps suppress early laundry fire by constantly monitoring the temperature in the drum
 - in case of excessive temperature, linen is sprayed with water

* only for OPL models with gas or steam heating

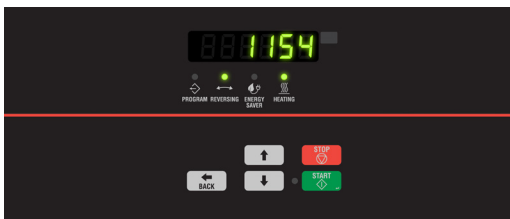

Quantum™ Gold Control



Easy Operation



Large Door Opening



Low Energy Consumption



High Output

On-Premises Tumble Dryers

Specifications

SA055NNN	
CAPACITY	
Capacity [kg]	24
Drum volume [l]	490
Drum diameter [mm]	Ø838
AIRFLOW	
Airflow [l/s]	330
Make Up Air (cm2)	929
DRYING AVERAGE	
Gas heating [g/min]	485
Electric heating [g/min]	371
MOTOR	
Fan [kW]	0,4
Drive [kW]	0,4
GAS HEATING	
Energy [kW]	32,8
Energy [kBTU/h]	112
Electrical connection	Single Phase 240V / 50Hz / 1 Refer to Installation Guide Prior to fitout
Gas connection [NPT]	½"

STEAM HEATING	
High pressure 6,9 bar [kW]	-
[kBTU/h]	-
Electrical connection	Single Phase 240V/50Hz / 1
Steam connection [NPT]	-
ELECTRICAL HEATING	
Energy [kW]	27
Electrical connection	3 Phase 415V/50Hz / 3 Refer to Installation Guide Prior to fitout
Circuit Breaker / FLA	
Exhaust [Ø /mm]	200
DIMENSIONS	
Size H×W×D [mm]	1700×875×1350
Net weight (E) [kg]	200
Net weight (G,S) [kg]	195
TRANSPORT DATA	
Packed (foil) H×W×D [mm]	1790×900×1450
Gross weight (foil, E) [kg]	220
Gross weight (foil,G,S) [kg]	215
Packed (crate) H×W×D [mm]	2210×1020×1520
Gross weight (crate, E) [kg]	300
Gross weight (crate,G,S) [kg]	295

Model	A	B	C	D	E	F	G
SA055	810	680	850	1350	1700	775	875

Refer to Installation Guide prior to fitout for Energy Safe requirements for make up air intake and the minimum required service space behind units, and space around unit. (610mm)

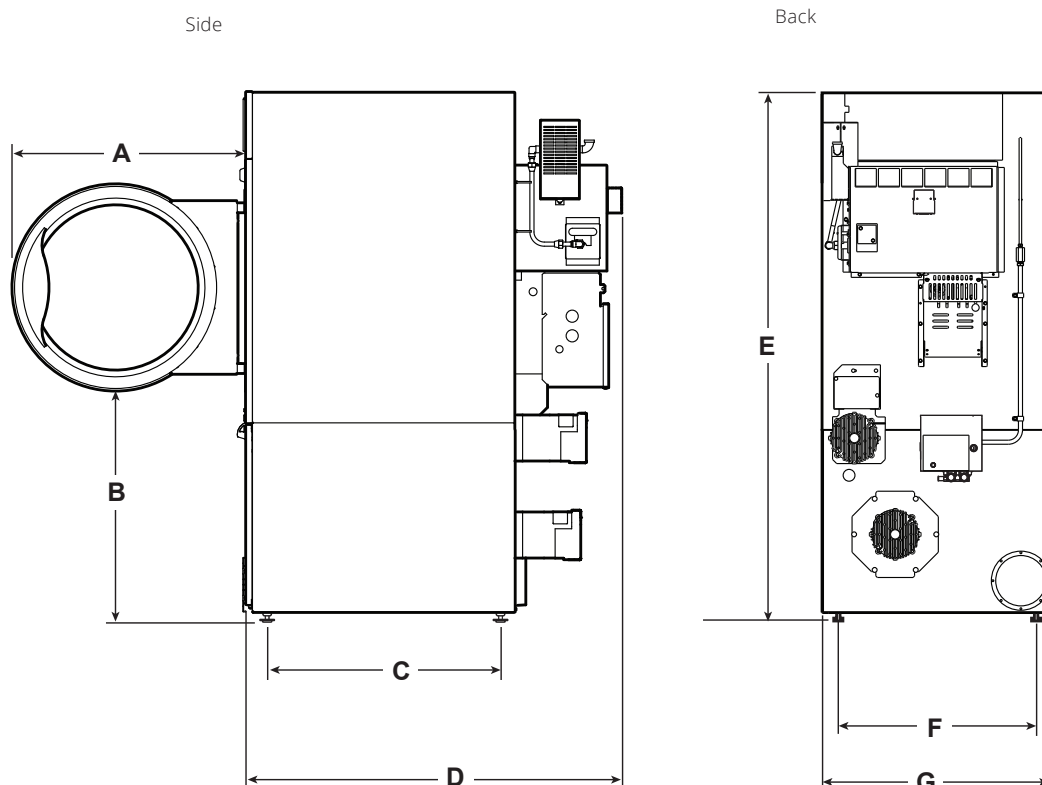

Contact Speed Queen Equipment Sales for further details:
E: info@speedqueensales.com.au