

# Operating

1. Prepare laundry
2. Clean lint filter by wiping lint out of screen area
3. Load dryer half full with laundry 9 kg maximum loading capacity
4. Close door

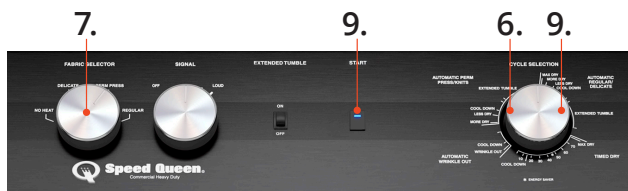

5. Turn on dryer by pressing power/cancel (Electronic control only)
6. Set cycle
7. Set temperature or fabric selector
8. Set dryness level (Electronic control only)
9. Press start or push timer knob in to start
10. Remove laundry from dryer once cycle has ended



ADE3TR - ADGE3TR control (Electric Models)

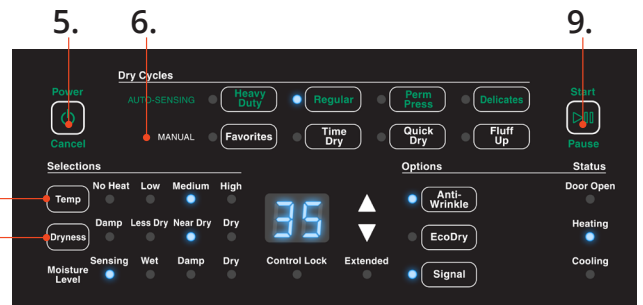

ADEE8B- ADGE8B - ADEE9R -ADGE9R control

# Installation

2. Connect exhaust system.
  - Dryer must be exhausted to the outdoors
  - Use 4 in (102 mm) rigid duct
  - Maximum straight duct length = 65 ft (19.8 m). Each elbow deduct 10 ft (3 m)
  - Sufficient make-up air must be supplied. The free area of any opening for outside air must be at least 40 in<sup>2</sup> (25806 mm<sup>2</sup>) per unit

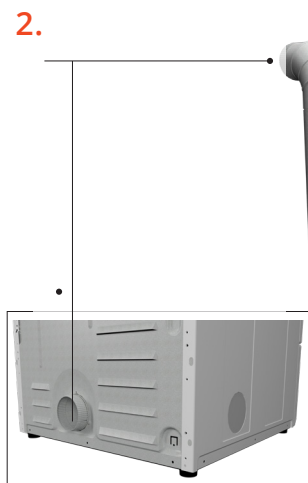

Retighten connections and recheck for leaks.

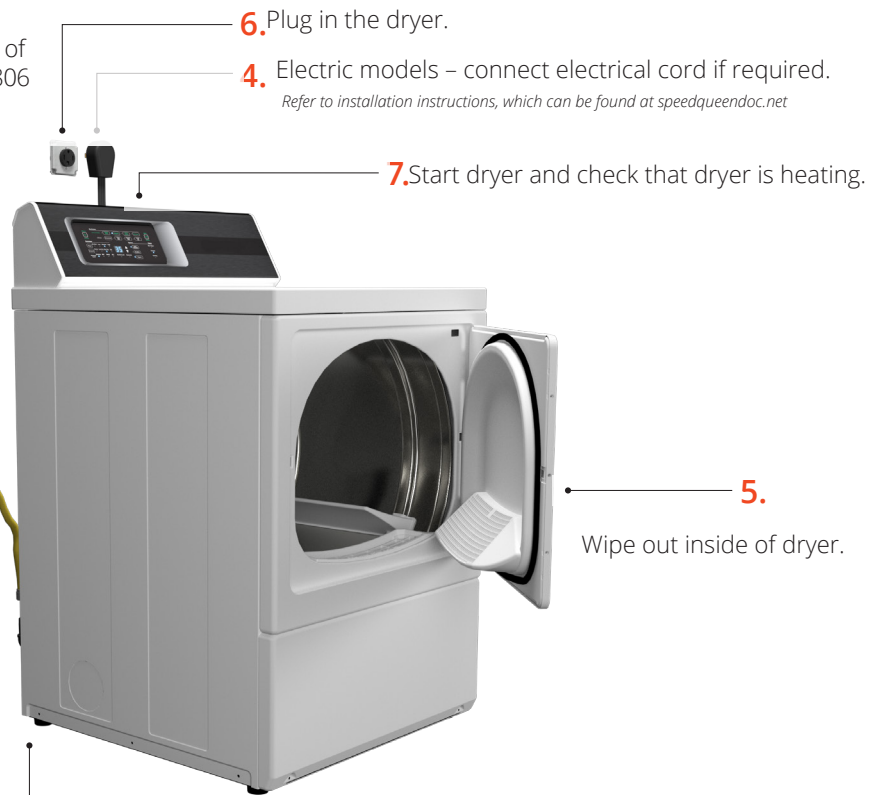

3. Gas models – connect gas supply pipe. Gas service to a gas dryer must conform with the local codes and ordinances and be connected by a licensed professional.

Refer to installation instructions, which can be found at [speedqueendoc.net](http://speedqueendoc.net)

Turn on gas and check all pipe connections (internal and external) for gas leaks by applying a non-corrosive leak detection fluid to the fittings. If bubbles are present then a leak is likely. Retighten connections and recheck for leaks.

1. Position and level the dryer.
  - Recommended rear clearance minimum is (51 mm) for utility connections and (152 mm) when venting through rear of unit